

EXHAUST EXTRACTION KIT:

1. 337mm Centrifugal Fan
2. High Temperature Exhaust Duct
3. Exhaust Attachment
4. High Temperature Exhaust Coil

SPECIFICATION SHEET: CENTRIFUGAL FAN 337MM

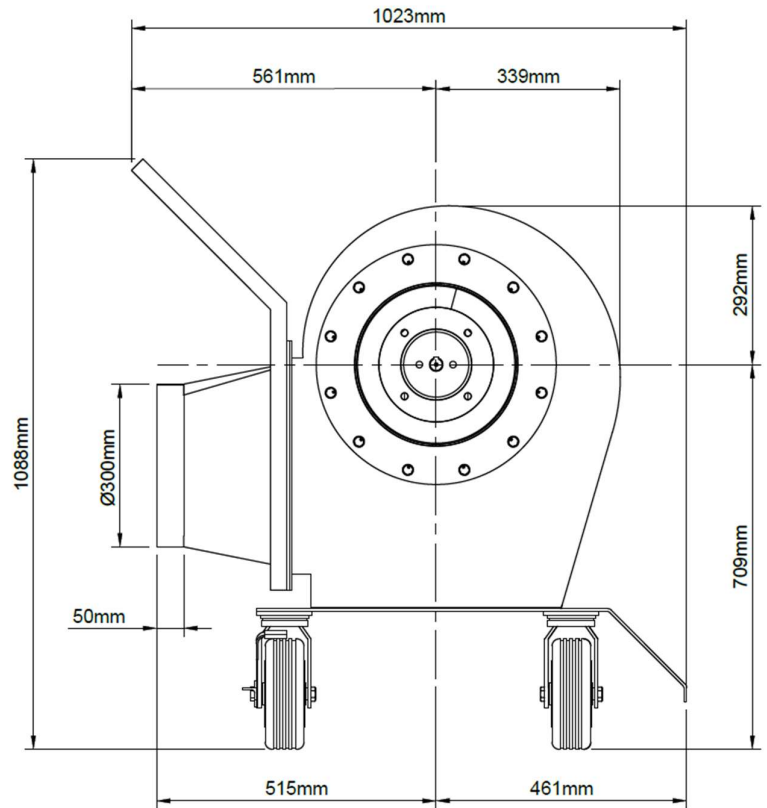
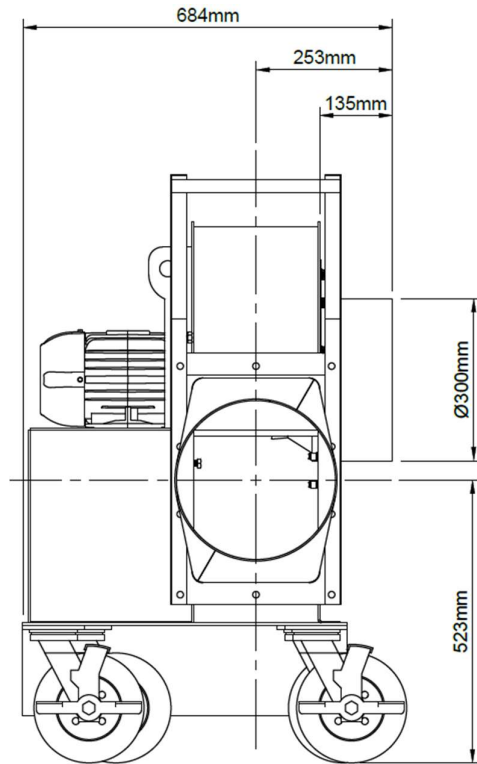

SPECIFICATIONS

Airflow (m³/hr):	5,800
Motor Power:	2.2kW, 2900rpm
Current Draw	4.8A
Voltage & Connection	240V, 1-Phase, 10A
Duct Diameter:	300mm
Dimensions LxWxH (mm):	1023 x 684 x 1088mm
Weight:	100kg
Lifting Method:	Forklift/Lifting Slings
Options:	Silencers Zones 1/2/21/22 20 Amp Plug Speed Controller
Temperature:	Range: -20°C to +55°C <i>*High-Temperature available on request</i>

FAN CURVE

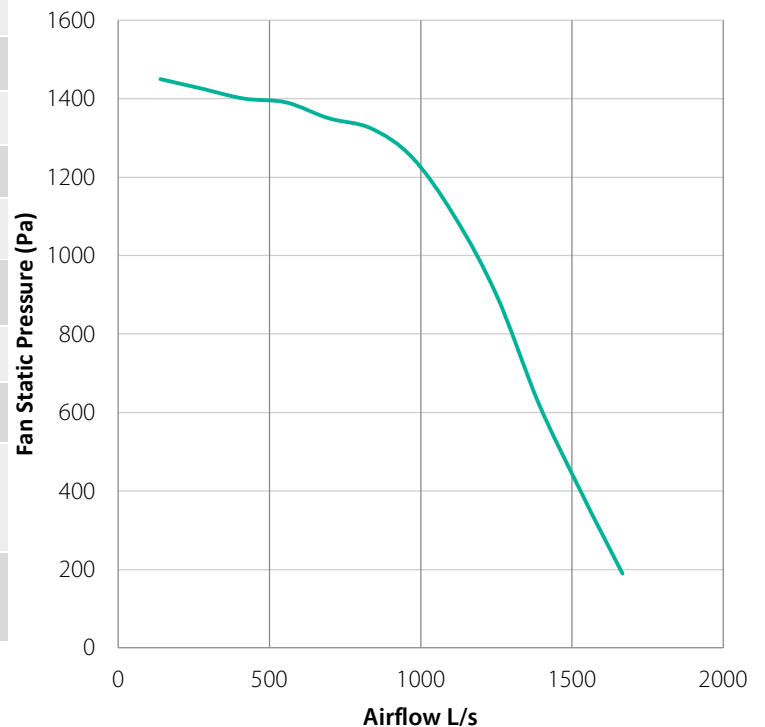

SPECIFICATION SHEET: HIGH TEMPERATURE DUCT, EXHAUST ATTACHMENT



HIGH TEMPERATURE DUCT

Connects to:	337mm Fan
Diameter	300MM



EXHAUST ATTACHMENT

Connects to:	300mm Fan/High Temperature Exhaust Coil
--------------	---

SPECIFICATION SHEET: HIGH TEMPERATURE EXHAUST COIL



HIGH TEMPERATURE EXHAUST COIL

Connects to:

Exhaust Attachment / Fume Source