

HIGH QUALITY, EASY, RELIABLE MOTORISATION FOR ROLLER SHUTTERS



SIMU T5 Auto

240 VOLT WIRED

**ELECTRONIC TUBULAR MOTOR
WITH FULLY AUTOMATIC LIMIT
SETTINGS**



INTELLIGENT, QUICK, EASY, SAFE, RELIABLE & EASILY INTEGRATED

Save time and save money with the SIMU T5 Auto! This fully automatic motor takes all the hassle out of setting limits thanks to its fully automatic limit settings (removing the need for assembler/installer training). Simply plug it in and the motor takes care of the rest thanks to its intelligent electronics. The T5 Auto will automatically stop in the top and bottom limits by sensing the resistance. Ideal for roller shutters the T5 Auto range also incorporates obstacle and frost detection and will automatically stop when the motor over torques and senses resistance or obstacles helping protect the user, their property and the roller shutter. This system must be used in conjunction with rigid fasteners and bottom bar stoppers. When in the fully closed position the T5 Auto locks down the roller shutter curtain making it very difficult for intruders.

TWO LIFTING CAPACITIES

The high performance T5 Auto is available in 2 different torques (10Nm, 20Nm).

STURDY, QUALITY CONSTRUCTION

SIMU tubular motors are made in France and are reputed for high quality and reliability.

Other features include:

- Obstacle and frost detection
- Fully automatic limit setting meaning no end-limit adjustment required (must be used with rigid fasteners and bottom bar stoppers)
- When using rigid fasteners, the roller shutter is locked down when in the fully closed position
- Thermal cut-out protection system
- Suitable for a wide range of adaptations and tube sizes.



CW PRODUCTS
HOME AUTOMATION & ROLLER SHUTTERS



MOTOR DIMENSIONS

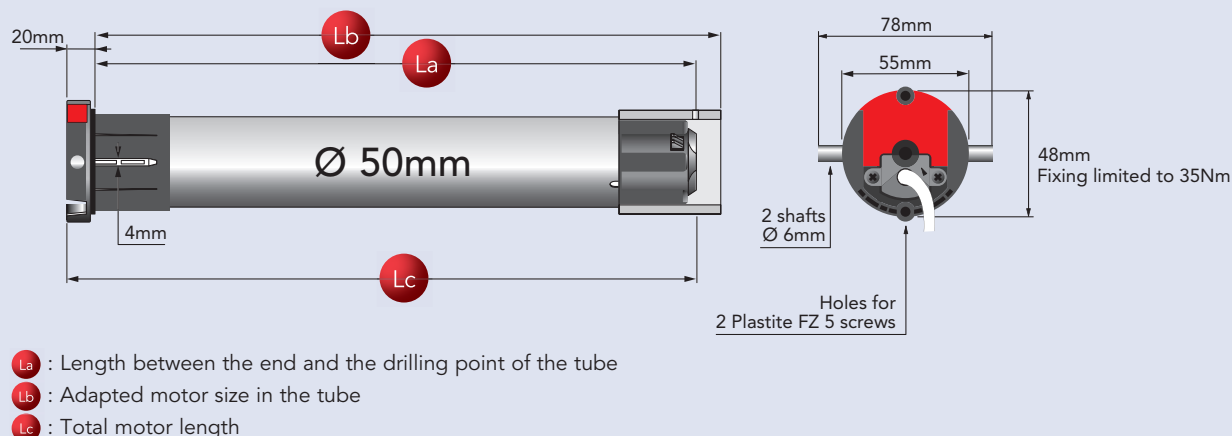

MODEL NUMBERS & TECHNICAL SPECIFICATIONS

Product Code	Model Number	Torque (Nm)	Speed (rpm)	Power (W)	Current (A)	L_a (mm)	L_b (mm)	L_c (mm)
30-801-510	T5 Auto - 10/17	10	17	120	0.50	486	496	508
30-801-520	T5 Auto - 20/17	20	17	160	0.75	660	670	682

GENERAL T5 Auto TECHNICAL SPECIFICATIONS

Power supply	240 Volts - 50 Hz
Thermal cut-out	4 minutes
End-limit switch with electronic counting	operating limited to 3 minutes
Protection index	IP 44
Ambient temperature of use	from -10°C to $+40^{\circ}\text{C}$ And exceptionally: from -20°C to $+70^{\circ}\text{C}$
Power supply cable	230V - 4 x 0.75mm^2 wires - white HO5 VVF, - 2.5m or 5m length
Automatic readjustment of the end-limit position	permanent
Base diameter for round tube	$\varnothing 50 \times 1.5\text{mm}$

Installation Note: Multiple motors cannot be wired to the same switch. A group controller is necessary when operation of 2 or more motors is required from 1 control point. Motors must be wired by a certified electrician. Horizontal mount only. Mounting brackets, crowns and driving wheels to suit tube size must be used with this motor.

MOTOR WIRING CONNECTIONS

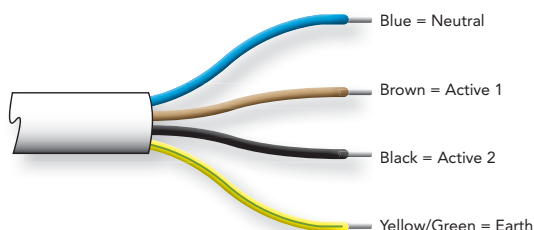

INTERNATIONAL STANDARDS

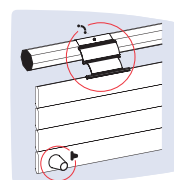

The T5 Auto offers fully automatic limit setting mode with the use of rigid fasteners and bottom bar stoppers.

General Note: All photos for illustrative purposes only. Technical specifications are correct at time of printing and may change without notice.

Exclusively distributed in Australia by **CW Products**
 126-138 Port Road Alberton South Australia 5014
Ph: (08) 8341 0120 **Fax:** (08) 8341 1750
Email: info@cwproducts.com.au **Web:** www.cwproducts.com.au

